

Miniair Nova  
Pneumatic Precision Drill for Vegetables



# Seed by Seed more Success!





Miniair Nova

Versatile, Precise, Economic!



2



cabbage

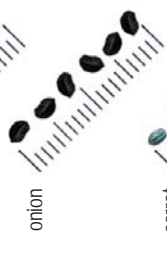

onion

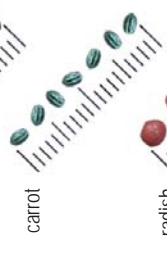

carrot

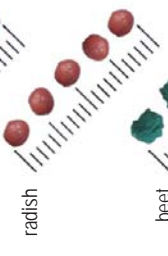

radish

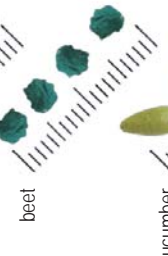

beet



cucumber



fennel

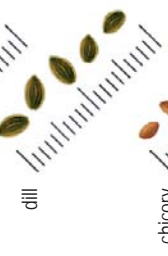

dill

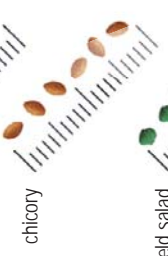

chitony

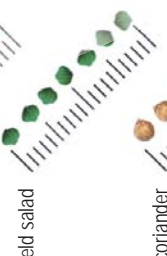

field salad



coriander





## From the Seed to the Carrot

The modern farmer is a producer of both raw materials and food. The key to economic success is growing fresh products that comply with the highest of quality standards. For the production of vegetables as the most important source of vitamins and nutrients in the human diet, this represents a huge challenge. Precise seed placement is the first, fundamental step on the way to producing top quality vegetable products.

As a competent partner and expert in drilling technology and precision sowing in particular, Kverneland Accord delivers the technological know-how: the MiniAir Nova! The particularly clear structure and the incorporated intelligent technology the machine is extremely user friendly and highly flexible, from setting to sowing.

The MiniAir Nova guarantees customised precision sowing for all sorts of vegetable seeds and is thus the ultimate machine for vegetable producers.

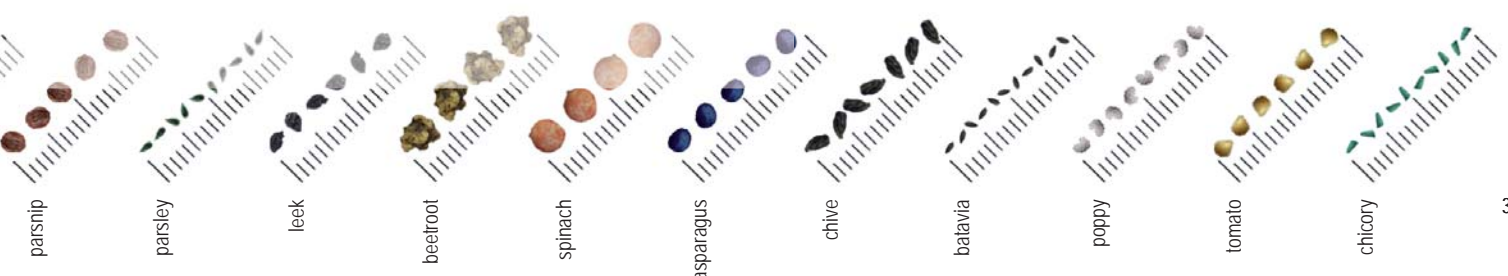



# Miniair Nova

## The Frame Concept – Lightweight and yet Sturdy!



The newly developed Miniair Nova is based on the familiar Monopill frame, available rigid or as a parallel hydraulic folding model, with working widths of 2 to 6.5m.

The 7.00-12AS tyres are standard fittings and ensure low soil impact during sowing. The wheels are positioned behind the toolbar in order to optimise weight distribution. They balance the machine, thus ensuring it remains exactly on track.

The machine can be adjusted to a height of up to 34cm for field, bed or ridged cropping systems via the holes on an adjustment bar on the wheel suspension.

The standard gearbox is fitted with an automatic chain tension adjustment device and allows seed spacing of 0.9 – 43.4cm. The chain wheels can be changed without the need for tools.





Parallel hydraulic folding frame 6m

Parallel hydraulic folding frame



Rigid frame  
from 2 to 6.5m



# Perfect Sowing Units

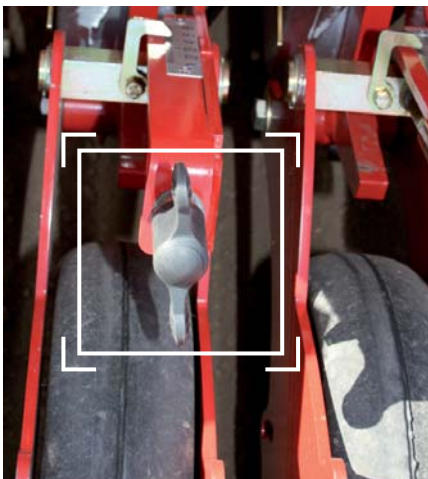
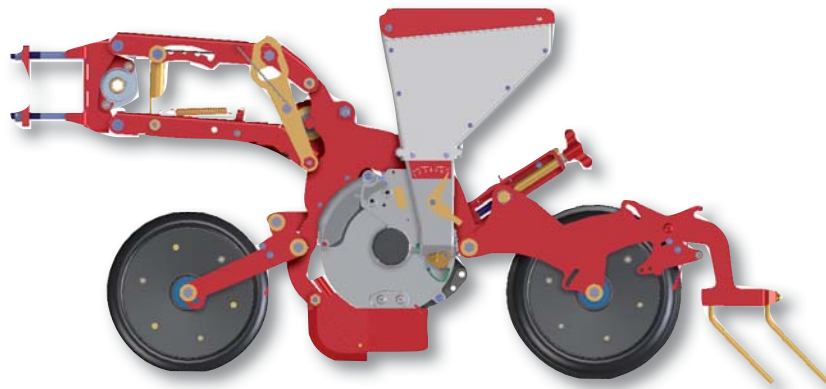

The new sowing unit concept consists of a parallelogram-linked tandem waggon with a hitched sowing unit. The downward weight of the unit can be reduced or increased as required via a spring loaded suspension system.

Linked front and rear press wheels ensure a consistent sowing depth. The sowing depth can be set quickly and easily via a spindle on the tandem waggon. Once the first row is set, a scale ensures the depth is applied to all rows.

The individual sowing units are attached to the basic frame with a claw hitch. This allows the distance between rows to be set easily and individually to a minimum width of 11cm. Weighing just 28kg, the standard version of the single sowing unit puts the emphasis on manoeuvrability, whilst maximizing stability.





Double row  
min. 24cm



Twin row  
min. 21cm



Single row  
min. 11cm



Double row

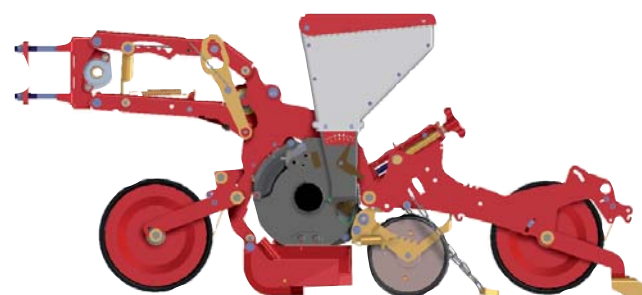

Twin row

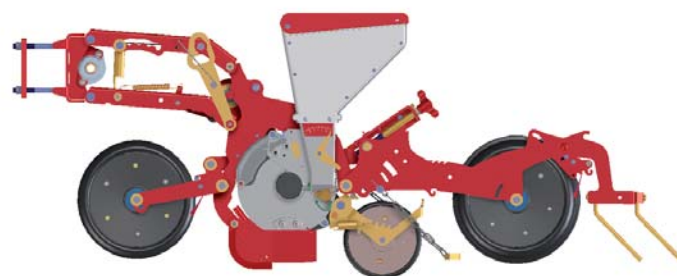

Single row

A new lifting mechanism allows the sowing unit to be raised and locked in position for maintenance work or if the tank is to be emptied completely.

The sowing unit can be fitted with various different press wheels, so that it is possible to adjust it according to soil quality. There is also a long version of the tandem waggon, which can optionally be fitted with an intermediate press wheel and additional chain coverer.



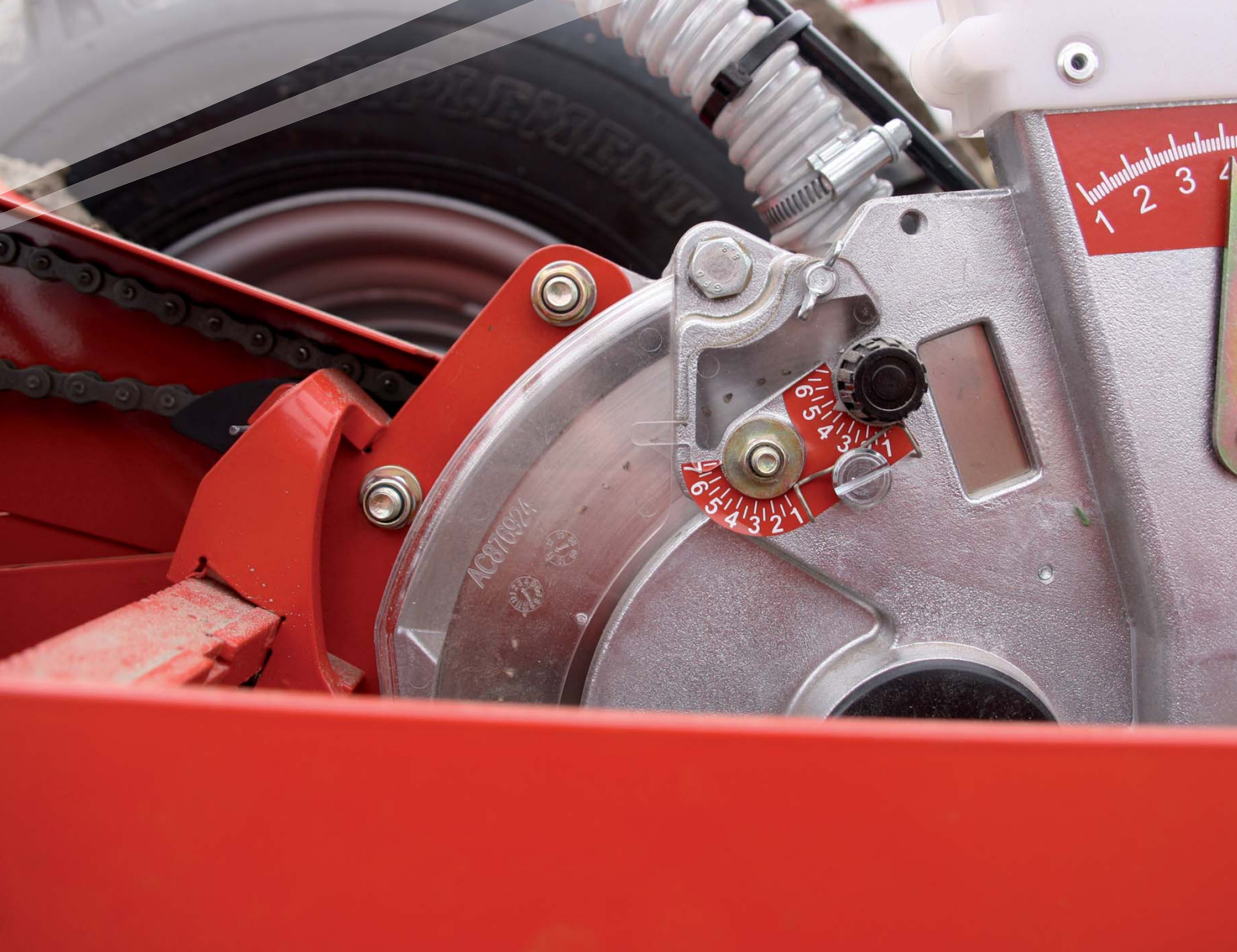

## The Seeding Heart – the Core of the Machine!

The seeding heart is made of cast aluminium and guarantees highly accurate seed placement thanks to its sophisticated technological design.

Individual seeds are sucked to the holes in the seed discs by a vacuum and proceed then via the rotating disc to the ejection area, where the vacuum is interrupted and the seed is placed precisely in the soil.

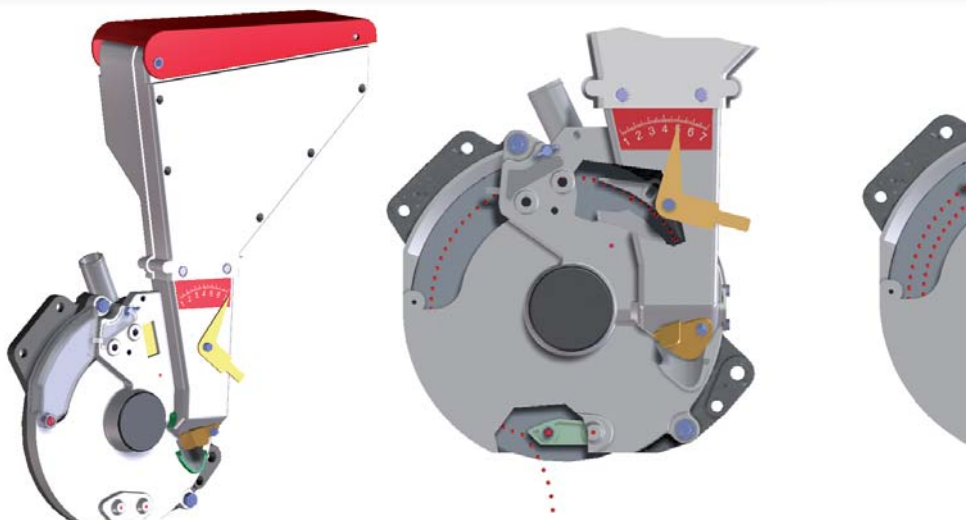



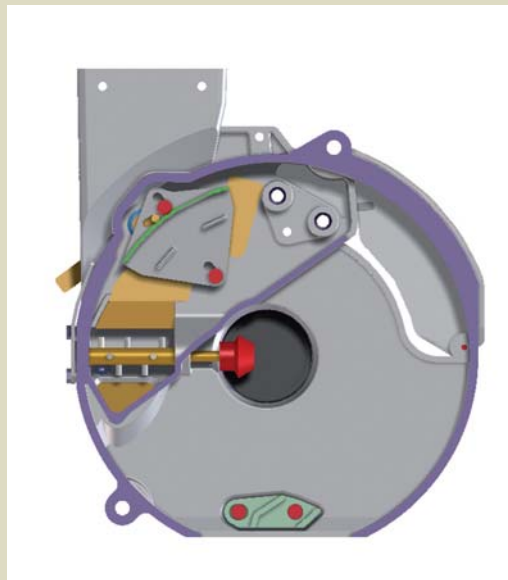

Surplus seed at the holes is removed with the help of adjustable singulators and returned to the seed flow. The feeding of seed from the 4 l plastic seed hopper is regulated with the help of a baffle plate, so that the flow of surplus seed back to the intake is guaranteed at all times. A rotary brush at the seed flow prevents blockages and bridging, ensuring a consistent supply of seed to the seed disc.

A small air jet clears the holes in the seed disc of any dust or seed residue to ensure perfect pick-up every time. The shape of the nozzle is patented. It is mounted on bellows and easy to change.



The seeding heart is easy to open and can be fitted with all sorts of different seed discs. These can also be changed easily and without the need for tools thanks to the special seed disc mounting.

A flap on the hopper makes it easy to empty it entirely, if needed. Alternatively, any leftover seeds can be removed by using the vacuum that is attached to the frame. The vacuum cleaner is also practical for cleaning and maintenance work.

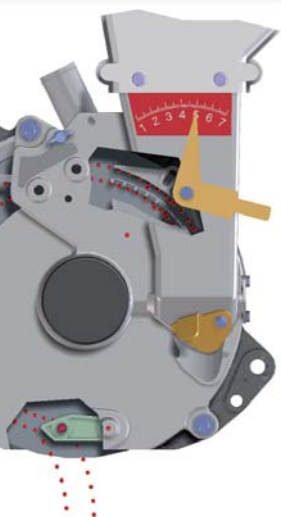



# Seed Coulters for Exact Placement



When it comes to choosing a seed coulter, there are various interesting options. It is for example possible to choose between the standard coulter for normal placement, a band coulter for wide placement, and a sickle-shaped coulter for deep placement.

New in our range is the twin coulter. In this case the standard seed coulter comes in two sections that make it possible to plant two rows of seed using one seeding heart.

This twin seed coulter is available in 7cm and 10cm widths, with a minimum distance between rows of 21cm.

The “two-lane” seed disc staggers the placement of the seed, thus optimizing the spatial distribution of individual plants in order to make best use of nutrients, light and water.

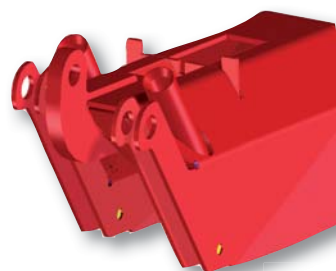

7 cm

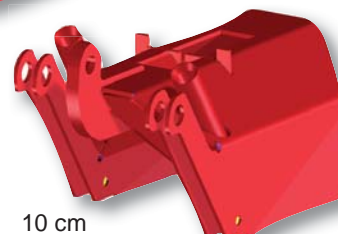

10 cm



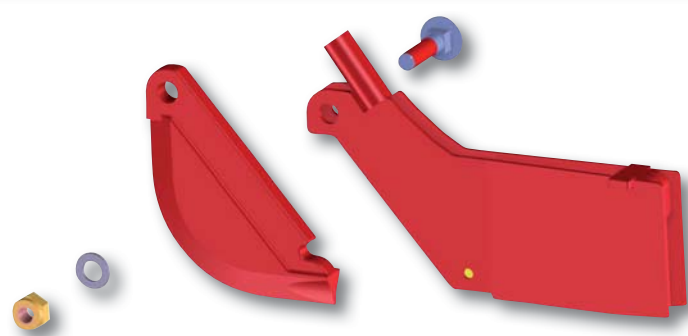

The standard and twin seed coulters are both fitted with a quick-fit share-point that can be changed easily in case of wear.

A wind flap at the end of the coulters ensures precise seed placement even in windy conditions.

A micro-granule applicator is a standard fitting on every drill.

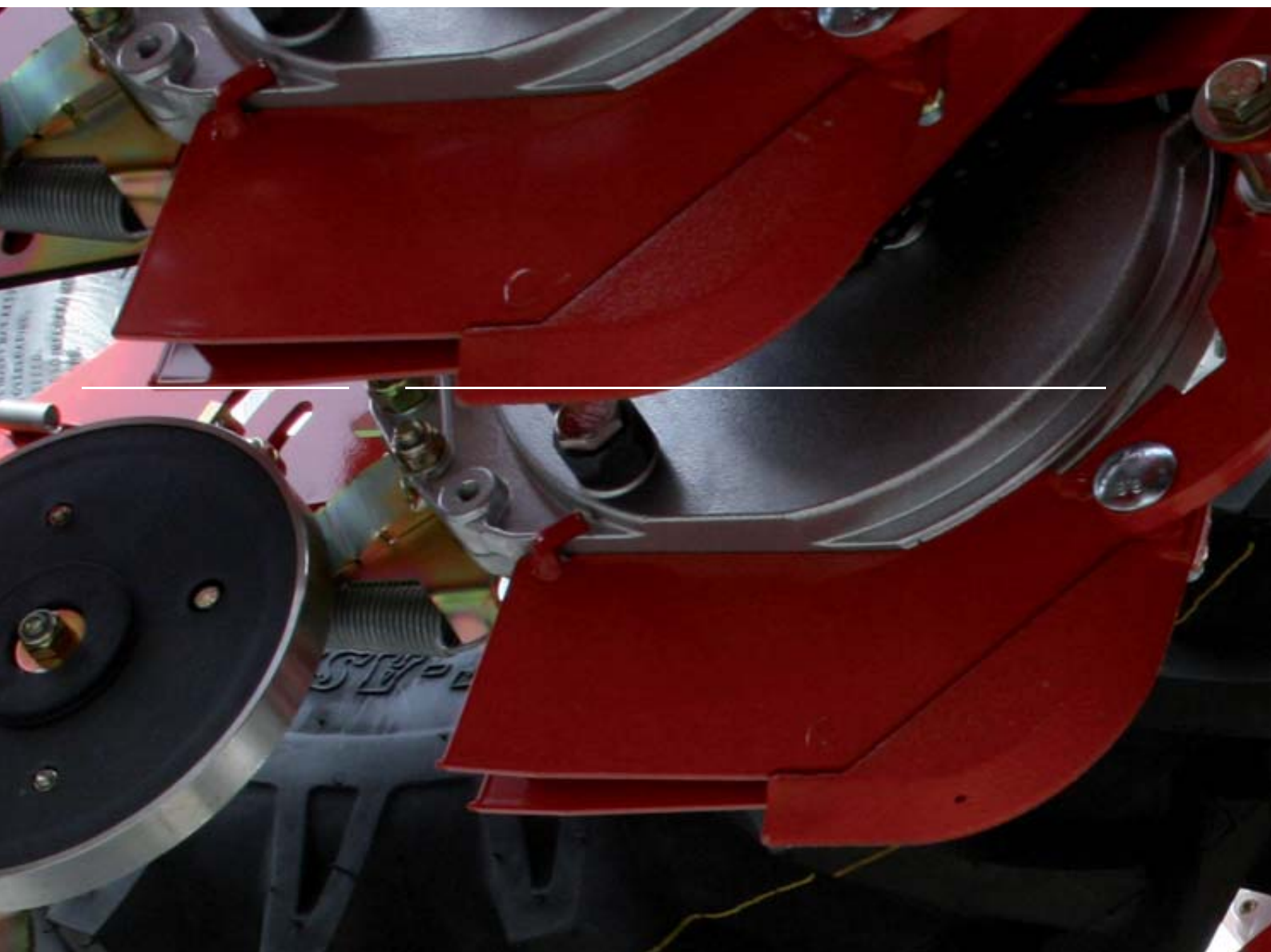



Miniair Nova

The Professional for all Vegetable Growers!



The Miniair Nova combines functional design with precision and productivity. Exact seed placement, high speed, and easy handling. That saves time and guarantees success. By professionals for professionals!





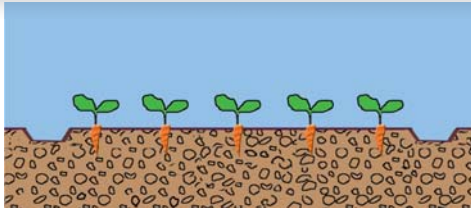

**Sowing on flat ground**

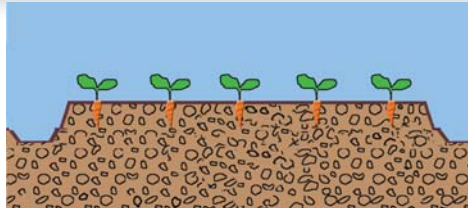

**Sowing on beds**

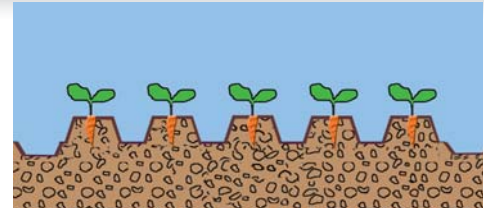

**Sowing on ridges**

### **Sowing on beds**

Ridge sowing is mainly done on soil which tends to stagnant water. Especially with light-coloured and humid soil, it results in a quicker warming in spring. The roots reach deeper soil layers faster. By creating the ridges, the field is divided into crests and furrows. In the ridge furrows there is the option to grow underseed.





# Miniair Nova Equipment

## Single sowing unit Miniair Nova

### Standard fittings:

1. Farmflex press wheel smooth 280 mm
2. Standard seed coulter
4. Farmflex press wheel with bead ring
5. Tine coverer

### Optional fittings:

3. Chain coverer

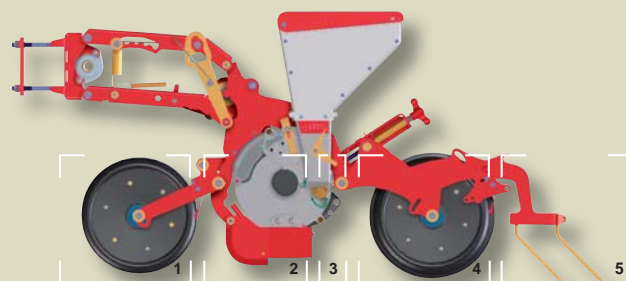

### Different models:

- 1.1 Farmflex press wheel smooth 280 mm
- 1.2 Press wheel, stain steel smooth
- 2.1 Standard seed coulter
- 2.2 Twin coulter (7 cm / 10 cm)
- 2.3 Band sowing coulter
- 3.1 Intermediate press wheel, stain steel
  - 3.1.1 With chain coverer
  - 3.1.2 Adjustable coverer
- 3.2 Intermediate press wheel, rubber

- 4.1 Farmflex press wheel smooth 280 mm
- 4.2 Press wheel, stain steel smooth
- 4.3 Farmflex press wheel with bead ring
- 5.1 With trailed rear coverer
- 5.2 Tine chain
- 5.3 Adjustable coverer
- 5.4 Crumbler

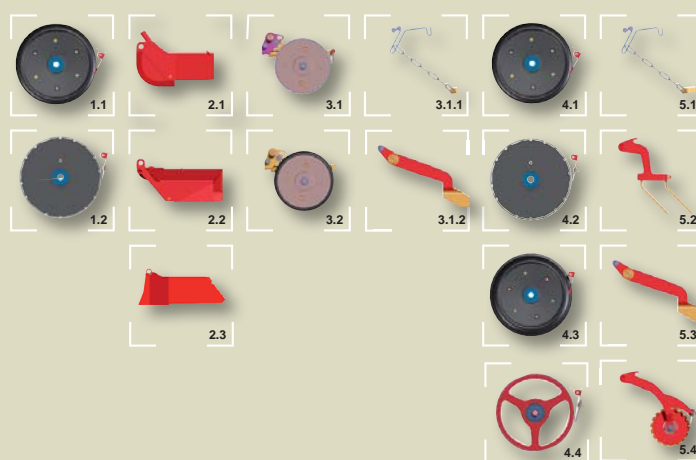

## Double sowing unit Miniair Nova

### Standard fittings:

1. Farmflex press wheel smooth 280 mm
2. Standard seed coulter
4. Farmflex press wheel with bead ring
5. Tine coverer

### Optional fittings:

3. Intermediate press wheel with chain coverer

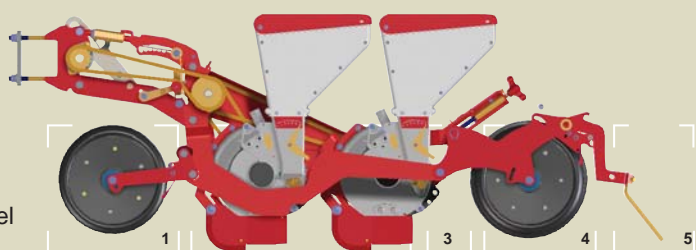

### Different models:

- 1.1 Farmflex press wheel smooth 280 mm
- 1.2 Press wheel, stain steel smooth
- 1.3 GFlat wide farmflex press wheel, 250 x 140mm
- 2.1 Standard seed coulter
- 3.1 Intermediate press wheel, stain steel
  - 3.1.1 With chain coverer
  - 3.1.2 Adjustable coverer
- 3.2 Intermediate press wheel, rubber

- 4.1 Farmflex press wheel smooth 280 mm
- 4.2 Press wheel, stain steel smooth
- 4.3 Farmflex press wheel with bead ring
- 5.1 With trailed rear coverer
- 5.2 Tine chain
- 5.3 Adjustable coverer
- 5.4 Crumbler

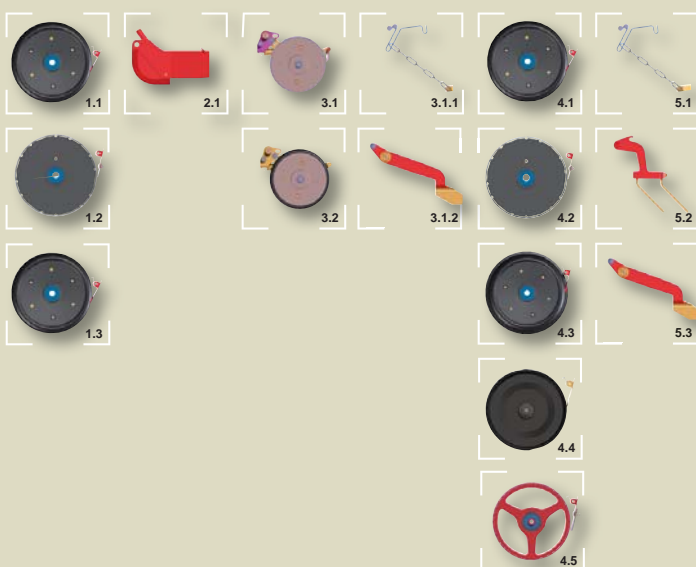



# Technical Data

MINIAIR NOVA Frame	2.00 m rigid	2.50 m rigid	3.00 m rigid	3.50 m rigid	4.00 m rigid	4.50 m rigid	5.00 m rigid	6.00 m rigid	6.50 m rigid	6.00 PHR
Drive 540 rpm	●	●	●	●	●	●	●	●	●	●
Drive shaft (Walterscheid)	●	●	●	●	●	●	●	●	●	●
Hydraulic fan drive	○	○	○	○	○	○	○	○	○	○
Tyres 7.00-12 AS; 2.0 bar Tyres 7.00-12 AS; 2.0 bar	●	●	●	●	●	●	●	●	●	●
Standard gearbox	●	●	●	●	●	●	●	●	●	●
Various chainwheels for additional sowing distances	○	○	○	○	○	○	○	○	○	○
Track marker, manually operated	○	○	○	—	—	—	—	—	—	—
Single/double acting Trackmarker	○	○	○	○	—	—	—	—	—	—
Hydr. folding Trackmarker	—	—	—	—	○	○	○	○	○	○
Microgranular applicator	○	○	○	○	○	○	○	○	○	○
Vacuum emptying device	○	○	○	○	○	○	○	○	○	○
Lighting bracket	○	○	○	○	○	○	○	○	○	○
Support legs	●	●	●	●	●	●	●	●	●	●
Hectaremeter, mechanical	○	○	○	○	○	○	○	○	○	○
Number of rows, max. (single sowing unit)	10	14	19	23	28	32	32	32	32	32
Weight of frame (kg)	345	355	360	380	655		670	680		970

MINIAIR NOVA Sowing Unit (without seed disc)	Single sowing unit	Twin sowing unit	Double sowing unit
Parallelogram hitch with integrated chain drive	●	●	●
Sickle-shaped coulter with quick-locking mechanism	●	●	●
Band sowing coulter	○	○	—
Twin coulter 7 cm width	—	●	—
Twin coulter 10 cm width	—	○	—
Intermediate press wheel, rubber	○	○	○
Intermediate press wheel, stain steel	○	○	○
Farmflex press wheel with bead ring	●	—	●
Various press wheels	○	○	○
Various seed discs	○	○	○
Row width cm	11	20	24
Row width within double sowing unit cm	—	—	5 - 11
Various coverers	●	●	●
Single hopper, volume (l)	4	4	4
Weight of sowing unit (kg)	28	40	54

- Standard equipment
- Accessories
- Not available for this model

Information provided in this brochure is made for general information purposes only and for worldwide circulation. Inaccuracies, errors or omissions may occur and the information may thus not constitute basis for any legal claim against Kverneland Group. Availability of models, specifications and optional equipment may differ from country to country. Please consult your local dealer. Kverneland Group reserves the right at any time to make changes to the design or specifications shown or described, to add or remove features, without any notice or obligations. Safety devices may have been removed from the machines for illustration purposes only, in order to better present functions of the machines. To avoid risk of injury, safety devices must never be removed. If removal of safety devices is necessary, e.g. for maintenance purposes, please contact proper assistance or supervision of a technical assistant.





## Kverneland Group

Kverneland Group is a leading international company developing, producing and distributing agricultural machinery and services.

Strong focus on innovation allows us to provide a unique and broad product range with high quality. Kverneland Group offers an extensive package of systems and solutions to the professional farming community. The offering covers soil preparation, seeding, forage- and bale equipment, spreading and spraying.



## Original Spare Parts

Kverneland Group spare parts are designed to give reliable, safe and optimal machinery performance – whilst ensuring a low cost life-cycle. High quality standards are achieved by using innovative production methods and patented processes in all our production sites.

Kverneland Group has a very professional network of partners to support you with service, technical knowledge and genuine parts. To assist our partners, we provide high quality spare parts and an efficient spare parts distribution worldwide.



Kverneland Group UK Ltd.  
Walkers Lane, Lea Green, St. Helens  
Merseyside, WA9 4AF  
Phone + 44 1744 8532 00

Kverneland Group Ireland Ltd.  
Hebron Industrial Estate  
Kilkenny, Ireland  
Phone + 353 56 51597

Kverneland Group  
4355 Kverneland  
Norway



[www.kverneland.com](http://www.kverneland.com)